

Item No. : EDF21AS/EDF21AB/EDF21AW

Installation guide

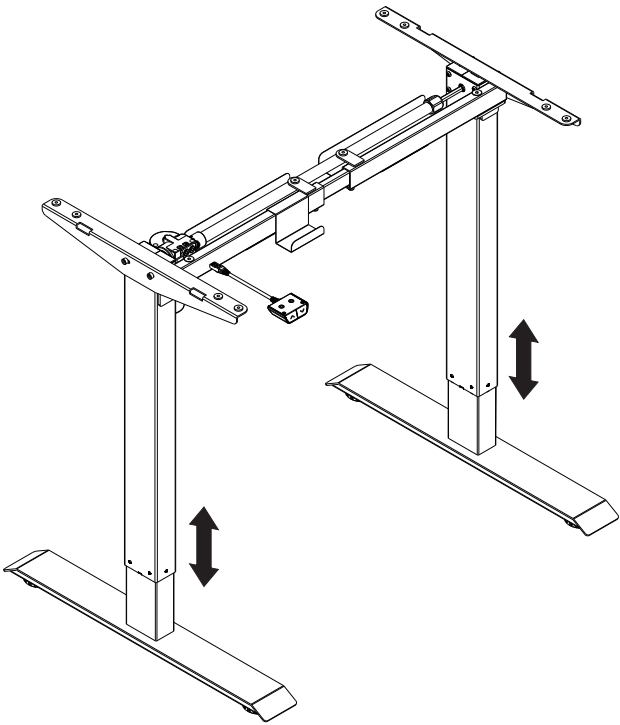

Technical data

Column Number	2
Maximum Load	70KG/154LBS
Max Speed	25mm/s
Input Voltage	100-240V
Lowest Position	710mm
Highest Position	1210mm
Desktop Size	1000-1600mm 500-800mm
Duty Cycle	Continuous operation for 2 mins at most after pause for 18 mins
Applicable Temperature	0~40°C

Accessory list

The drawings below are for references only. Actual contents might be slightly different.

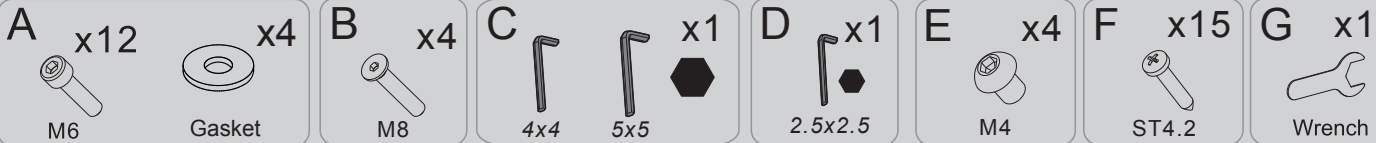

Part list

No.	Part	Qty	No.	Part	Qty	No.	Part	Qty
①	Pedestal	2	②	Left Column	1	③	Right Column	1
④	Supporting beam	1	⑤	Transmission rod	1	⑥	Supporting plate	2
⑦	Adapter	1	⑧	Baffle	2	⑨	Power cable	1
⑩	Cable tie	4	⑪	Adaptor holder	1	⑫	Handset	1
⑬	Switch cord	1	⑭	Control Box	1			

Installation instruction

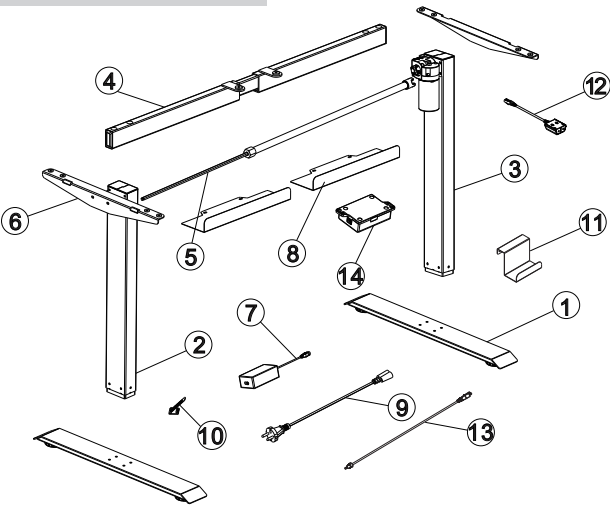

STEP1

Install Pedestal(1)

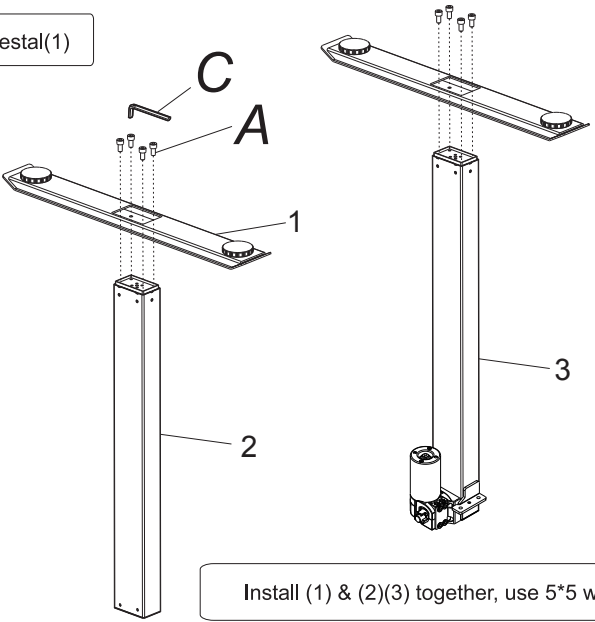
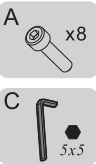

Install (1) & (2)(3) together, use 5*5 wrench(C) to tighten the screws(A).

STEP2

Install Supporting beam(4)

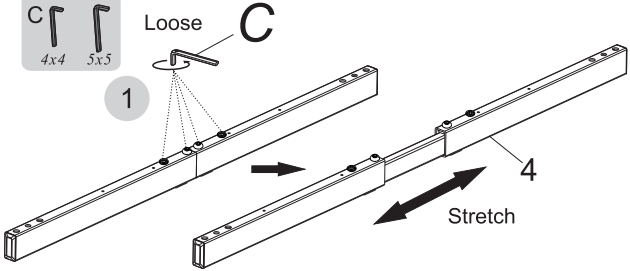
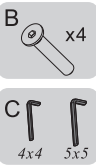

Loose screws on (4) with wrench 4x4(C), then stretch supporting beam

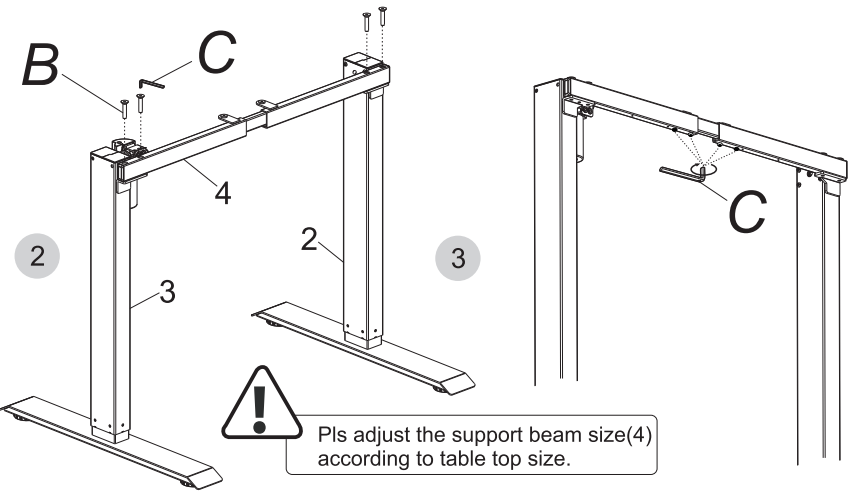

Install supoorting beam on the column (2)(3), tighten screw (B) with wrench 5x5 (C)

Tighten screws on supporting beam with wrench 4x4(C)

STEP3

Install transmission rod(5)

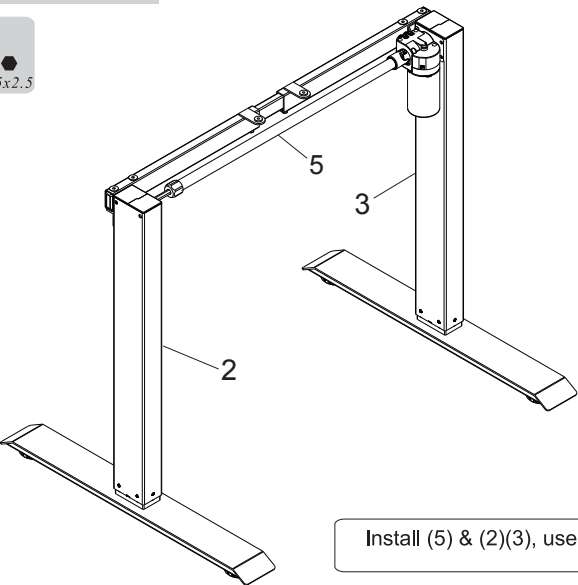

Install (5) & (2)(3), use 2.5*2.5 wrench(D) to tighten(G).

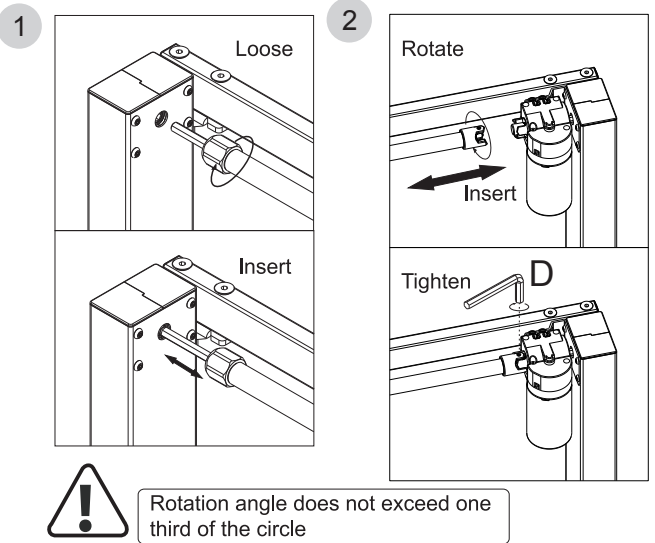

Rotation angle does not exceed one third of the circle

STEP4

Install supporting plate(6)

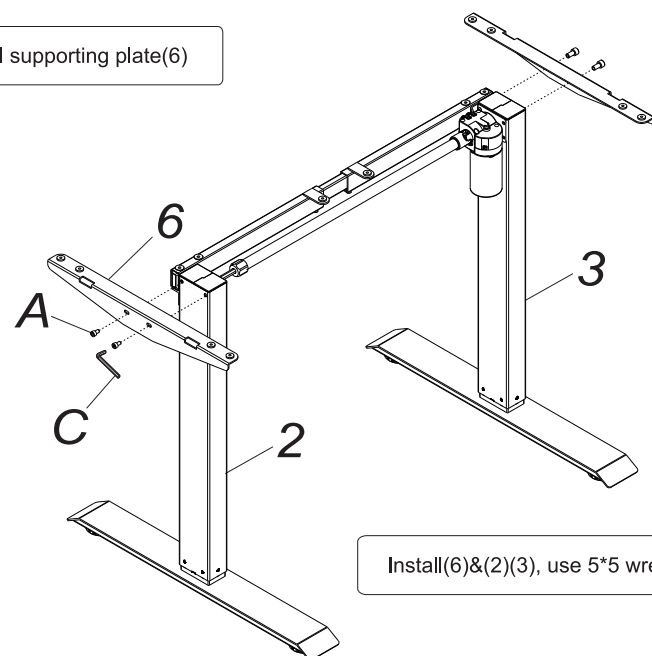
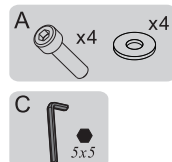

Install(6)&(2)(3), use 5*5 wrench(C) to tighten the screws(A).

STEP5

Install the power adaptor

Install the tabletop, control box and handset.

Connect the tabletop, control box(14) and the handset(12) with the screws (F), then lock it with pistol electric drill.



Self-prepare

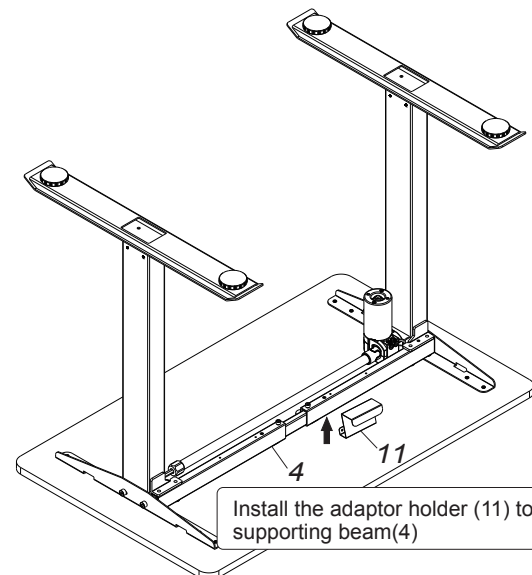

Install the adaptor holder (11) to the supporting beam(4)

The margins on the two sides need to be not larger than 200mm.

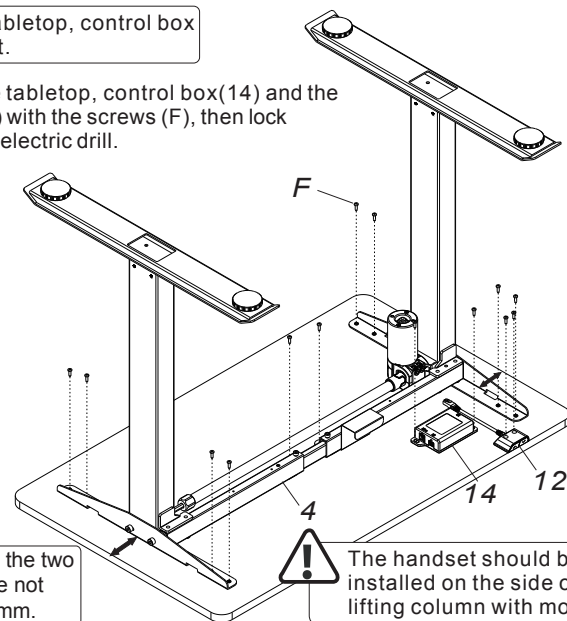

The handset should be installed on the side of the lifting column with motor.

STEP6-1

Tighten the supporting beam and the transmission rod screw

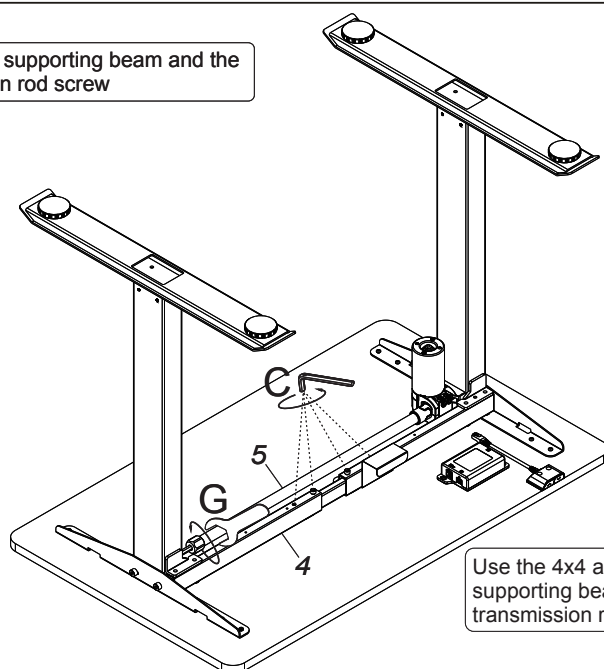

Use the 4x4 allen key (C) to tighten the 4 screws on the supporting beam (4), and then lock the nut on the transmission rod (5) with the wrench (G).

STEP6-2

Install baffle and power adaptor

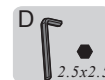
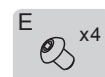

Install the baffle (8) to the supporting beam (4) using screws (E), and then lock with 2.5*2.5 wrench (D).

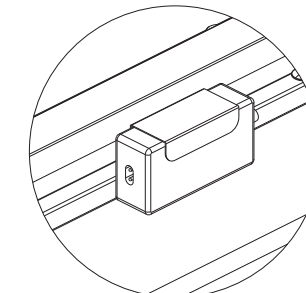
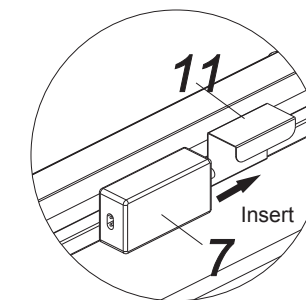
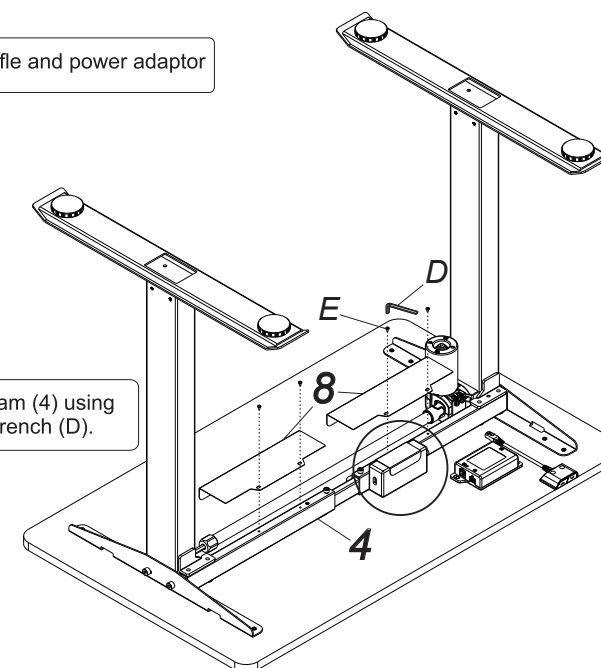

STEP7

Connect all cables to the adaptor (7)

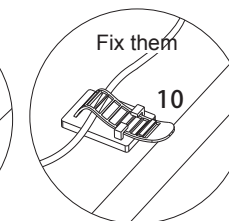
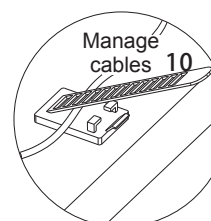
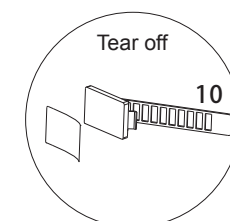
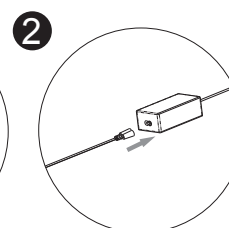
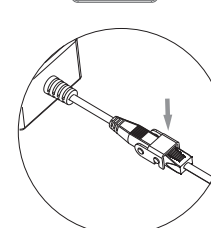
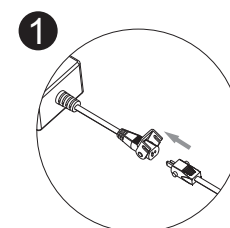
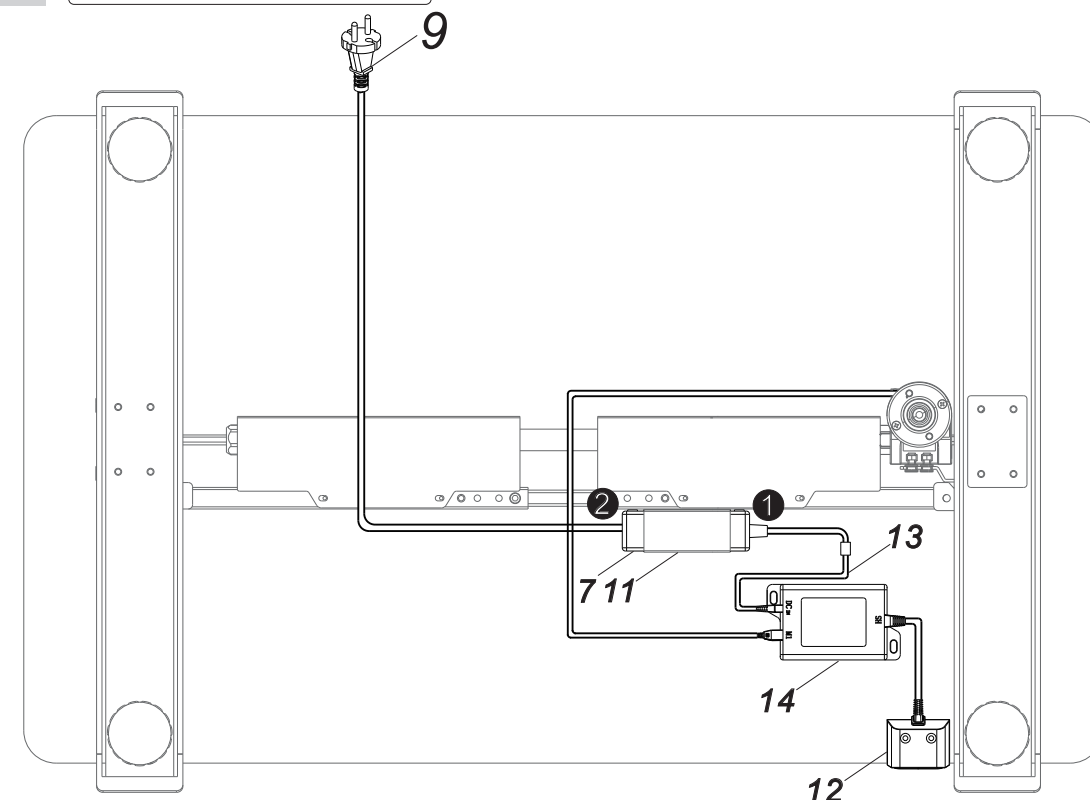

Use cable tie to fix all cables onto the table top.

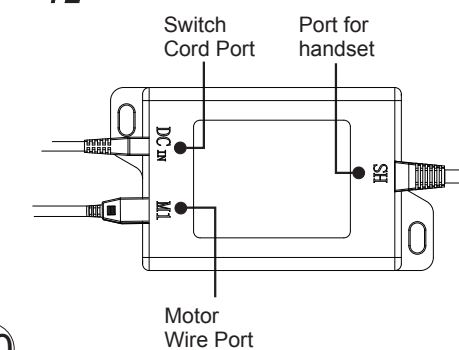

Common faults

The following tips will help you fix common errors and faults.
Please contact your supplier if the problem is not listed.

Error	Method
No response while pressing	Check if all the cables well connected;
Rising in a low speed	Check if overloaded, max loading: 70kg;
The desktop moving towards the opposite direction as ordered	Reset;
The desk moving downwards without any operation	Check if overloaded, max loading: 70kg;
Automatically Self-Reset	Check whether the power wire is still well connected;
Overload Operation	Restart after suspend for 18mins while connecting with power;
Can't reach the min or max height	Reset;



Attention

1. Power supply: AC100V-240V,50/60Hz
2. Service Environment: 0-40℃
3. Unplug the power plug before cleaning, wipe the dust on surface with slight wet dishcloth when cleaning, be careful not to let the drops into the internal parts, not loose the connector.
4. The electric box contains electronic components, metals, plastics, wires etc., so dispose of it in accordance with each country's environmental legislation, not the general household waste.
5. Check carefully to ensure correct and complete assembly before using.
6. Be familiar with all functions and program settings of the product before first use.
7. Children are forbidden to play on the product because of unforeseen action when playing, so any dangerous consequences caused by this improper action will not be on manufacturers.
8. Slight noise caused by the V-ribbed belt or brake system due to structure will not have any effect on the use of the equipment.
9. Corrosive or abrasive materials are forbidden to clean the equipment. Must ensure that the cleaner used will not pollute the environment.
10. This appliance can be used by children aged from 8 years and above and persons with reduced physical, sensory or mental capabilities or lack of experience and knowledge if they have been given supervision or instruction concerning use of the appliance in a safe way and understand the hazards involved. Children shall not play with the appliance.
11. Cleaning and user maintenance shall not be made by children without supervision.
12. If the supply cord is damaged, it must be replaced by the manufacturer, its service agent or a similarly qualified person in order to avoid a hazard.
13. Please make sure there is no hazard sources in your operating environment. e.g., do not litter the tools around. Always be careful to treat the packaging materials in order to avoid any possible danger, e.g. plastic bag may lead to choking hazard to children.
14. Keep the original package of the equipment if necessary in case of the future use in transportation.

Waste disposal



This marking indicates that this product should not be disposed with other household wastes. To prevent possible harm to the environment or human health from uncontrolled waste disposal, recycle it responsibly to promote the sustainable reuse of material resources. To return your used device, please use the return and collection systems or contact the retailer where the product was purchased. They can take this product for environmental safe recycling.

Allcam Mobile Products Ltd
Merit House, Stanhope Street, Birmingham B12 0UX, United Kingdom